

Service  
Service  
Service

# Service Manual

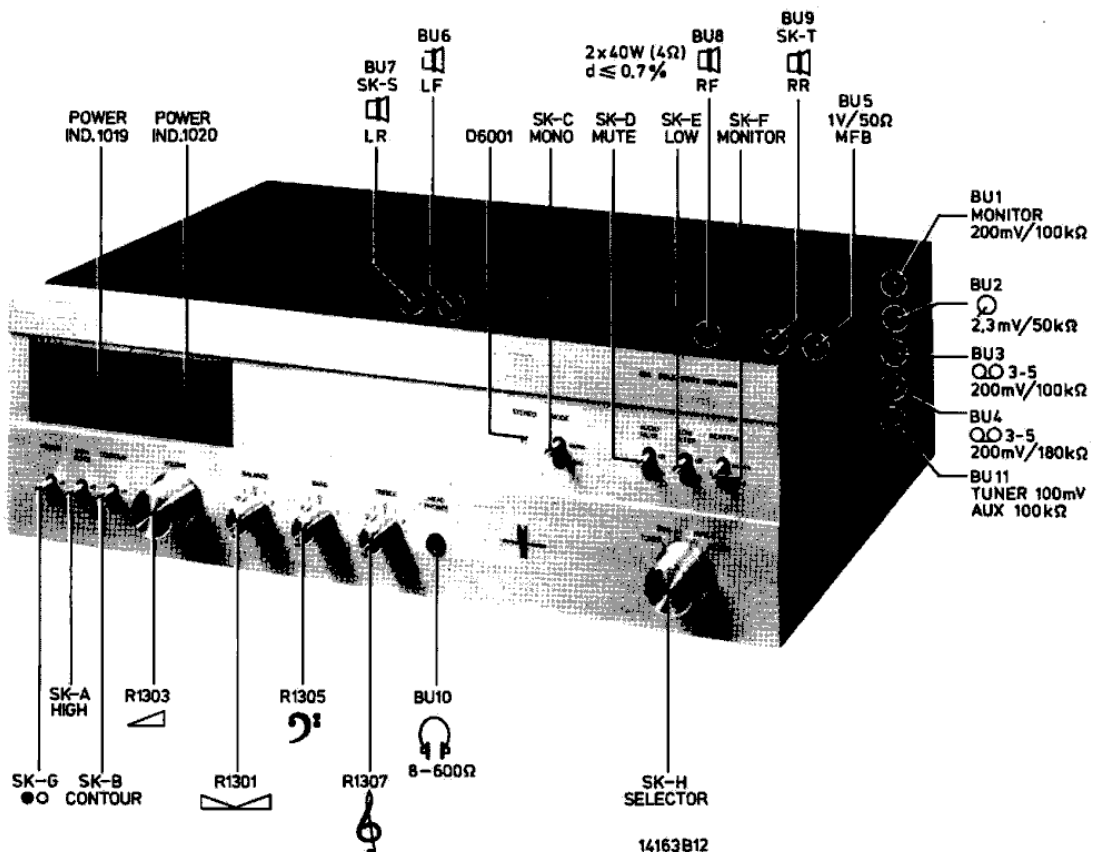





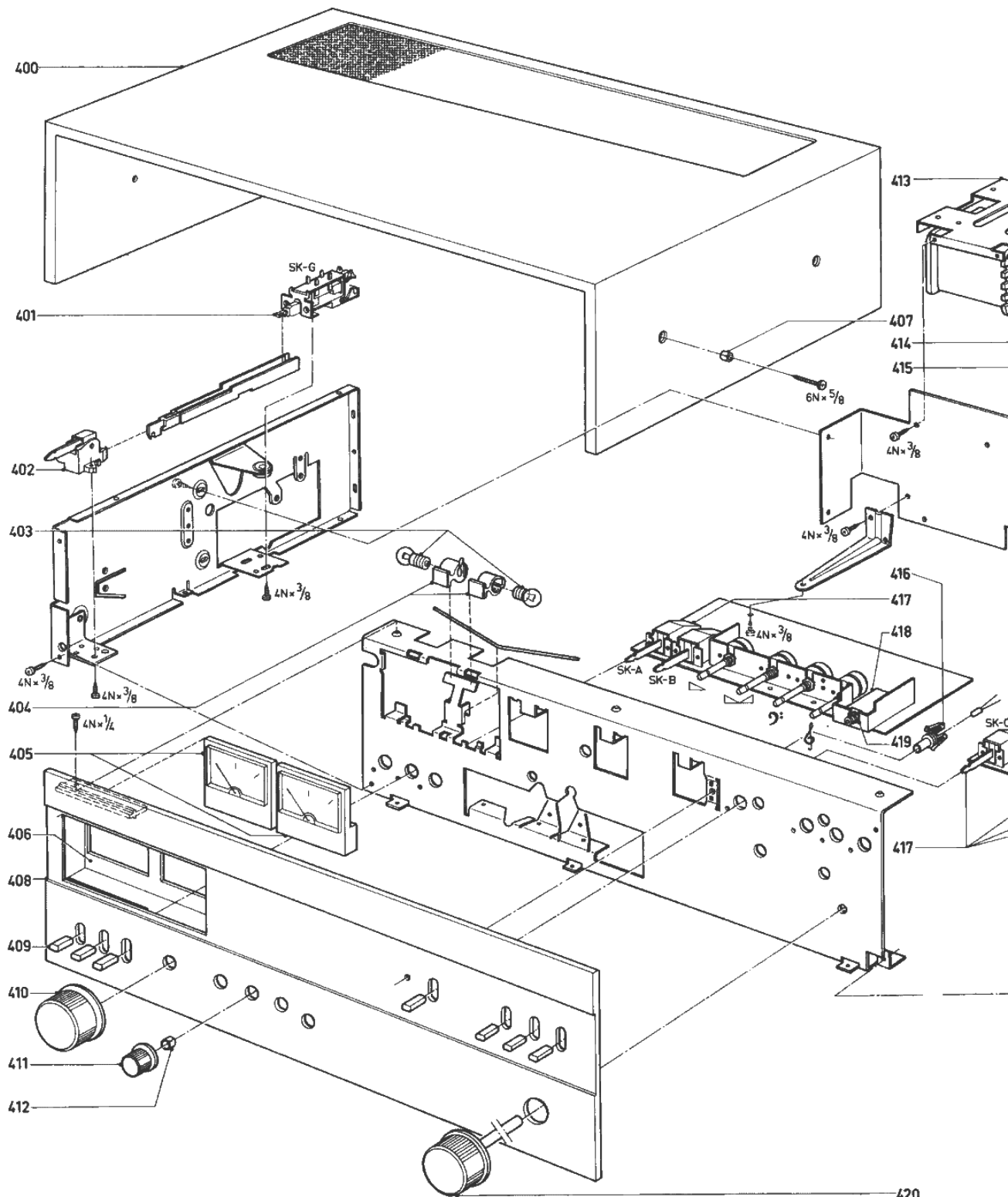





6406	BU9,6410,3420,BU5	6408	6404	MISC.
2410	2416,2420	2422		C
3414,3424,3428		3401...3429		R
3432,3430,3438,3440,3448,3434,3446,3450,3452		3430...3470		

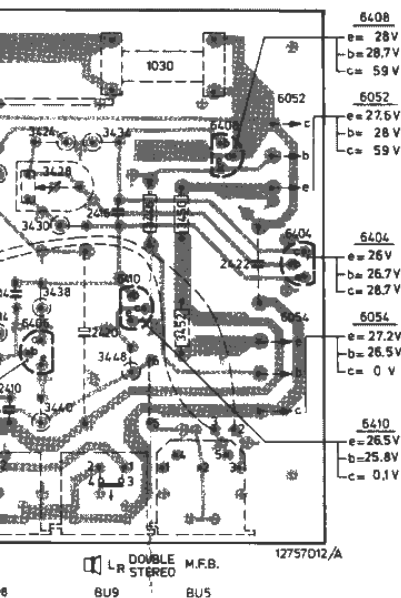

MISC.	SK-D	6552,6551	SK-E	SK-F	6561-6566,6555,6556	SK-C
C 2551...2568		2556,2554,2552		2553,2551,2555	2567,2568	2566,2565
R 3551...3562		3564-3566		3555-3563	3554,3553	3569-3580
					3551	3581,3582

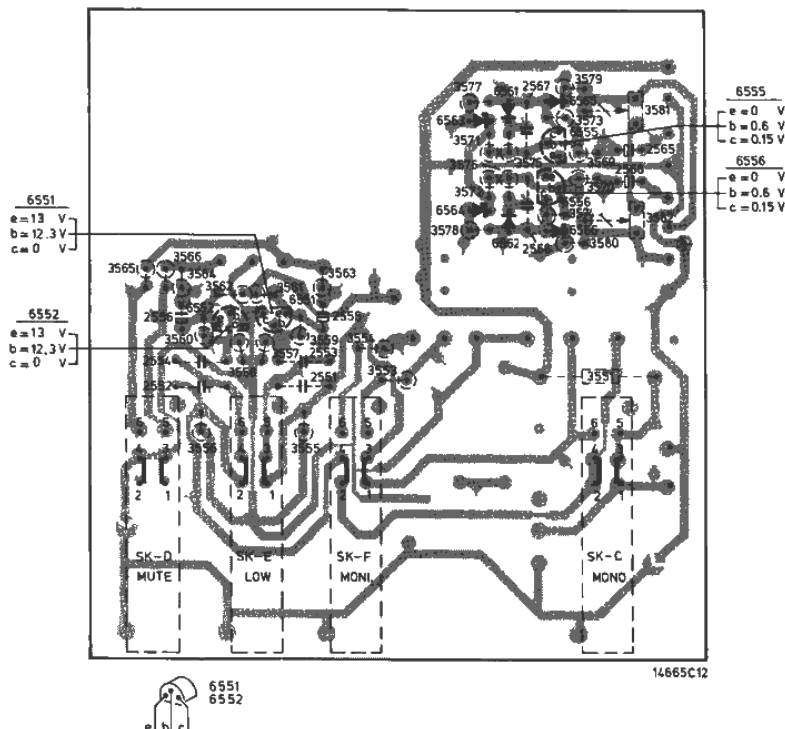

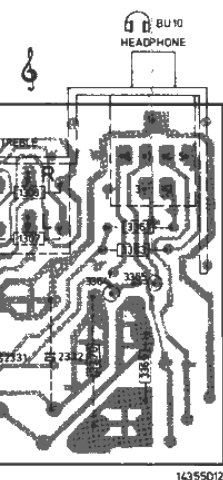

BU10	MISC.
2332	C
1308,1307	
3370,3361...3365,3369,3375...3370	R



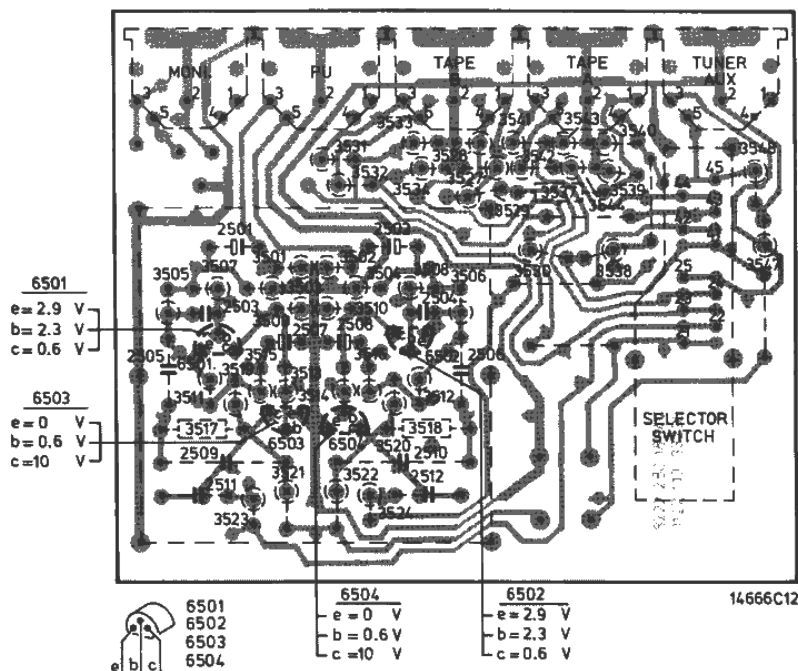

MISC.	6501	6503,6504	6502
C 2501...2512		2505,2511,2509,2503,2501,2507,2508,2502,2510,2504,2512,2506	
R 3501...3548		3501...3511	3512...3524,3531...3534,3527...3530,3537...3544
			3548,3547

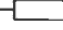

AF CONTROL PANEL



		
2309-2310	Elco 47 $\mu$ F - 10 V	
2321-2322	Micro poco 2.2 nF	4822 121 50415
		
1301-1302	Balance pot. 20K	4822 102 10144
1303-1304	Volume pot 50K	4822 102 10142
1305-1306	Bass pot. 50K	4822 102 10143
1307-1308	Treble pot. 50K	4822 102 10143
3370	Carbon res. 390 $\Omega$ - 1 W	4822 110 23096
		
6301-6302	BC559	4822 130 40963
6303-6304	BC548b	4822 130 40937
6307-6308	BC548b	4822 130 40937
6311-6312	BC548b	4822 130 40937
6313-6314	BC558b	4822 130 44197
6317-6318	BZX75/C2V1	5322 130 34049

FEATURE PANEL



		
2551-2552	Flat cap. 8.2 nF	4822 121 40147
2567-2568	Flat cap. 10 nF	4822 121 41134
		
3551	Carbon res. 1.8 k $\Omega$ - 1 W	4822 110 23114
3581-3582	Trimpot. 4.7 k $\Omega$	4822 100 10036
		
6551-6552	BC559b	4822 130 44358
6555-6556	BC548b	4822 130 40937
6561-6562	BAW62	4822 130 30613
6563-6564	BZX79/C22	5322 130 34441
6565-6566	BAW62	4822 130 30613

LF POWER PANEL

		
2051-2052	Elco 3300 $\mu$ F-55 V	4822 124 70264
2053	Elco 4700 $\mu$ F-63 V	4822 124 70198
2407-2408	Elco 47 $\mu$ F-10 V	
2425-2426	Flat cap. 47 nF	4822 121 40525
2434	Flat cap. spec. 220 nF	4822 121 40538
2435-2436	Flat cap. 47 nF	4822 121 40336

		
3403-3404	Metal film res. 150 k $\Omega$	5322 116 54713
3405-3406	Metal film res. 33 k $\Omega$	5322 116 50482
3419-3420	Metal film res. 6.2 k $\Omega$	5322 116 50608
3427-3428	Trimpot. 1 k $\Omega$	4822 100 10037
3431-3432	Metal film res. 10 k $\Omega$	5322 116 54619
3437-3438	Safety res. 56 $\Omega$	4822 111 30412
3445-3446	Safety res. 470 $\Omega$	4822 111 30411
3447-3448	Safety res. 10 $\Omega$	4822 111 30405
3449 ÷ 3452	W.W. res. 0.24 $\Omega$ - 2 W	4822 113 60122
3465	Safety res. 22 $\Omega$	4822 111 50346
		
6051-6052	BD313	4822 130 41154
6053-6054	BD314	4822 130 41155
6401-6402	BC558b	4822 130 44197
6403-6404	BC548	4822 130 40938
6405-6406	BC546b	4822 130 44461
6407-6408	BC637	4822 130 41041
6409-6410	BC638	4822 130 41087
6416	BD233	5322 130 44281
6417	BZX79/C36	5322 130 34098
6418	Bridge rectifier B80-C5500/3300	4822 130 50311

INPUT PANEL

		
2505-2506	Micro poco 18 nF	5322 121 54113
2507-2508	Elco 47 $\mu$ F-10 V	
2509-2510	Micro poco 5.6 nF	4822 121 50543
		
6501-6502	BC560b	4822 130 41124
6503-6504	BC550b	5322 130 44454

MISCELLANEOUS

F1029- F1030 D6001	Fuse 3.15A slow	4822 253 30027
	LED LD37/1	4822 130 30923
	Silicon grease	5322 390 20019
	Solder tag	5322 290 34028
	Mains lead with plug	4822 321 10084







D6317	TS 6307, 6311, 6313	TS 6555 D 6561, 6563, 6565			ME 1019	TS 6401	TS 6403, 6405, 6407, 6409, 6051 6053				M
D6318	TS 6308, 6312, 6314	TS 6556 D 6562, 6564, 6566			ME 1020	TS 6402	TS 6404, 6406, 6408, 6410, 6052 6054				M
2323	2325	2565	2567		2401	2403	2407 2413 2409 2415			2419 2051 2425	C
2324	2326	2566	2568		2402	2404	2408 2414 2416 2416			2420 2052 2426	C
1307	3351	3355	3363 3569 3571	3577 3579 3401	3403	3411	3423 3427 3429	3433 3455 3441 3445	3447 3449	3459	R
	3349	3357	3361	3575 3573	3581 3405	3419	3413 3415	3437 3439 3431 3421	3457 3451		R
1308	3352	3356	3362 3570 3572	3578 3580 3402	3404	3412	3424 3428 3430	3434 3456 3442 3446	3448 3450	3460	R
	3350	3358	3364	3576 3574	3582 3406	3420	3414 3416	3438 3440 3432 3422	3458 3452		R

